

# INDUSTRIAL BUILDING FOR LEASE



9255 Corbin Avenue • Northridge

**21,736 SF  
AVAILABLE**

*Situated within a planned Chatsworth Business Park this site offers a tenant the unique ability to have the facility finished to suit, from a mix of office and warehouse with 22' clear height to 100% office space. This space is currently designed with approximately 3,000 SF of office, however the Lessor is open to adding office space to suit. Wholesale-retail use may be possible as the site is located next to the Northridge Mall and numerous restaurants and retail services.*

For more information  
please contact:

**SCOTT CASWELL**  
Principal  
818.444.4911  
scaswell@lee-re.com  
License ID # 00853607

**ERICA OWENS**  
Associate  
818.444.4912  
eowens@lee-re.com  
License ID # 01481476

Lee & Associates® - LA North/Ventura, Inc.  
Corporate ID #01191898  
A Member of the Lee & Associates  
Group of Companies

26050 Mureau Road, Suite 101  
Calabasas, CA 91302  
P: 818-223-4388 F: 818-591-1450



COMMERCIAL REAL ESTATE SERVICES  
No warranty or representation is made to the  
accuracy of the foregoing information. Terms of sale  
or lease and availability are subject to change or  
withdrawal without notice.

## PROPERTY HIGHLIGHTS:

- Beautiful Modern Design
- Great Street Identity With Wholesale/Retail Exposure
- Lessor Will Add Office Improvements to Suite
- 22' Clearance & Heavy Power



For more information and photos visit: [www.northridgebp.com](http://www.northridgebp.com)

# INDUSTRIAL BUILDING **FOR LEASE**

9255 Corbin Avenue • Northridge

*Improvements shown are samples of recently remodeled adjoining space.*

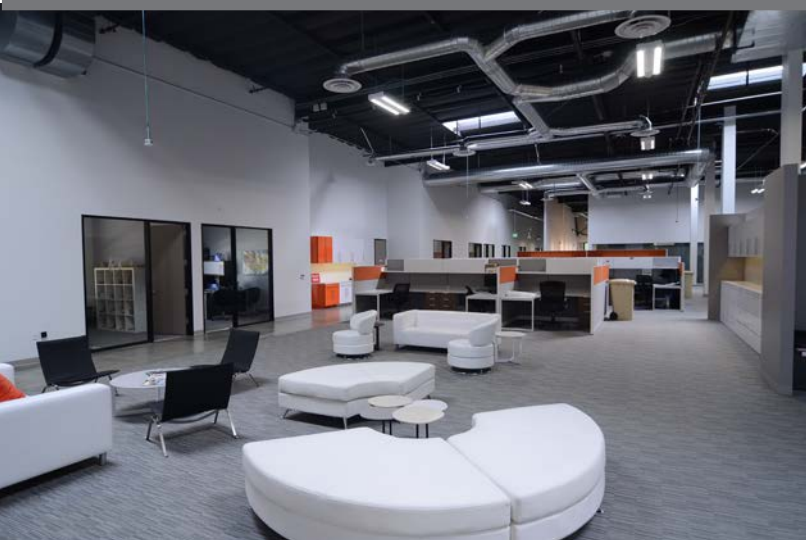

**SCOTT CASWELL**  
818.444.4911  
scaswell@lee-re.com

**ERICA OWENS**  
818.444.4912  
eowens@lee-re.com

No warranty or representation is made to the accuracy of the foregoing information. Terms of sale or lease and availability are subject to change or withdrawal without notice.

